

# Design Intent:

## Submission for Cleveland Public Art: Windworks

Great Lakes Science Center  
Cleveland, OH



The circular design is based on Man's earlier built forms primarily used for worshipping nature. Extrapolating on this idea the design evolved to open the circle into a set of spiraling arms, derived from a propeller spinning, which will wrap the plaza. By lessening the stringency of the rings the plaza becomes open enough to appear welcome and usable while remaining well defined.

The main axis of the sculpture run West-East, parallel to Erieside Ave. and utilizes an off axis entrance into the spaces center to maintain adjacency to the entry to the Science Center.

Concrete pillars make up individual forms that punctuate the main axis and circumference of the main plaza. These pillars are stepped up in height, the lowest being furthest from the center of the circle, until climaxing in 18' tall monolithic forms which flank seating areas facing the center of the circle and the tower holding the wind turbine. From the freeway and Mall C these pillars form an undulating wave shape drawing the eye up towards the turbine and creating a light playful form diametric to the concrete composition of its material. This is meant to encircle a dynamic piece of sculpture with a static one making the movement of the turbine all the more impressive.



Aerial photo with rendering of proposed site.

# Design Intent:

## Submission for Cleveland Public Art: Windworks

Great Lakes Science Center  
Cleveland, OH



The center space (plaza) provides room and seating for outdoor eating and possibly lectures or classes and is meant to be utilized by the science center to create more public interaction, where exterior functions can be recognized by the general public garnering even more attention to the Science Center.

At night the concrete pillars are lit towards the center of the main circle and therefore follow the "interior face" of the pillar's path creating a mix of backlighting and vertical lighting that will appear very dramatic from the city and the Shoreway.

The design provides no kiosk or virtual information center to display data from the turbine. I feel that this can be more appropriately handled within the Science Center and may disturb the simplicity of the turbine and the sculptured plaza.



View from Stadium

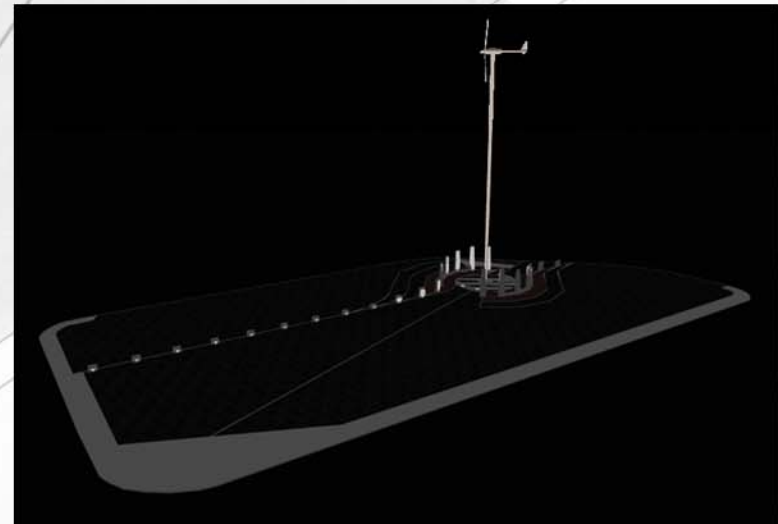

Turbine and Plaza at Night

Concept Drawings:

Submission for Cleveland Public Art: Windworks

Great Lakes Science Center  
Cleveland, OH

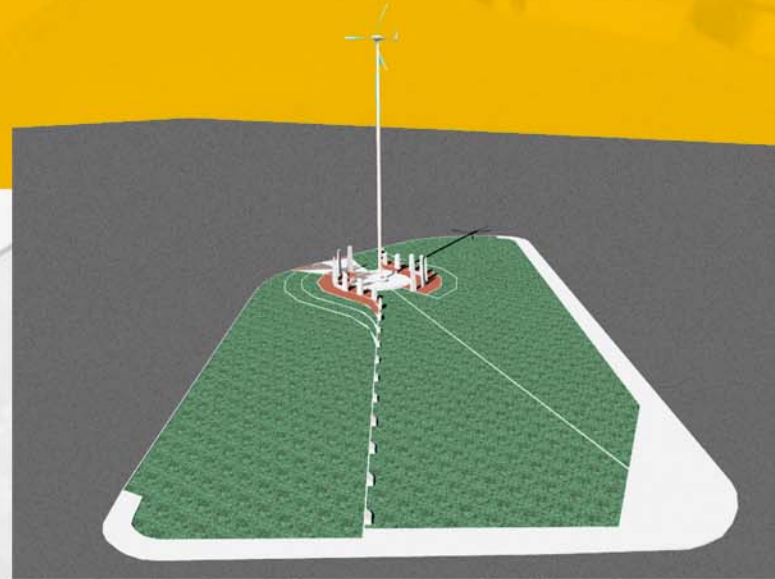

Long Axis Aerial

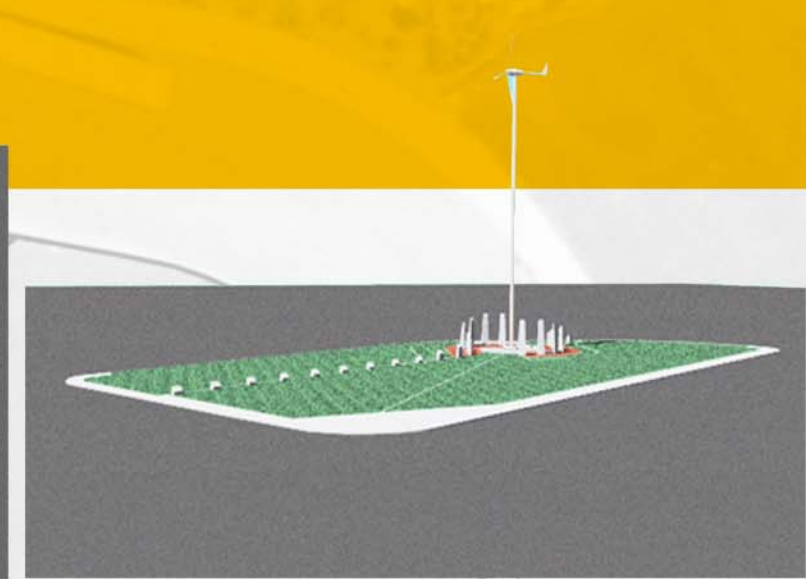

View From Shoreway Heading East



Rendering Towards Science Center Entrance

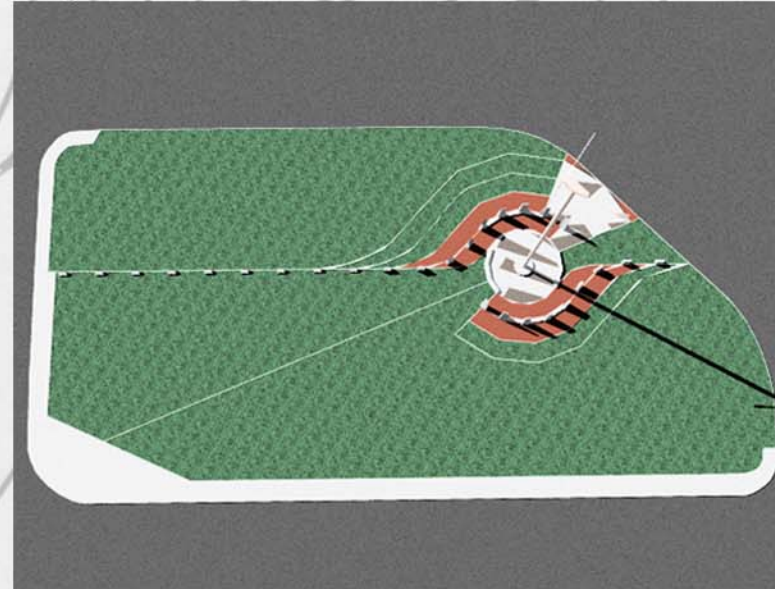

Site Plan

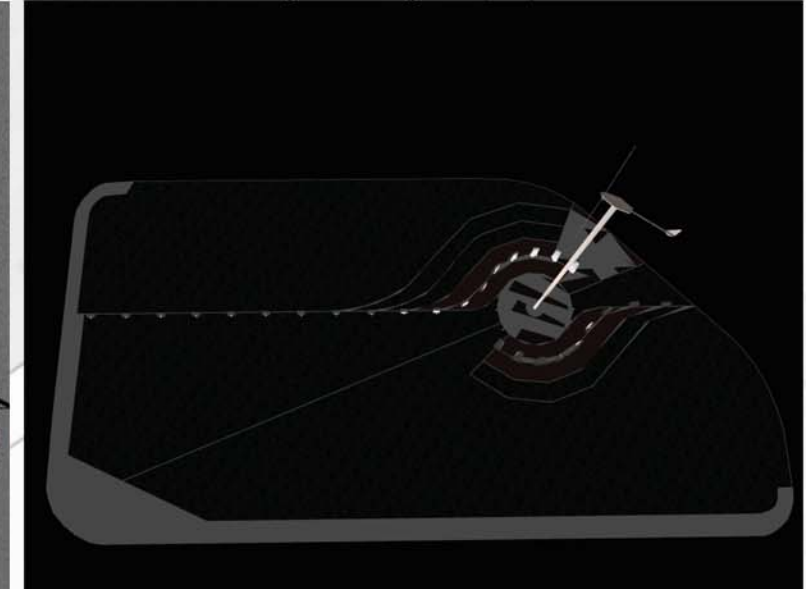

Night Rendering Plan

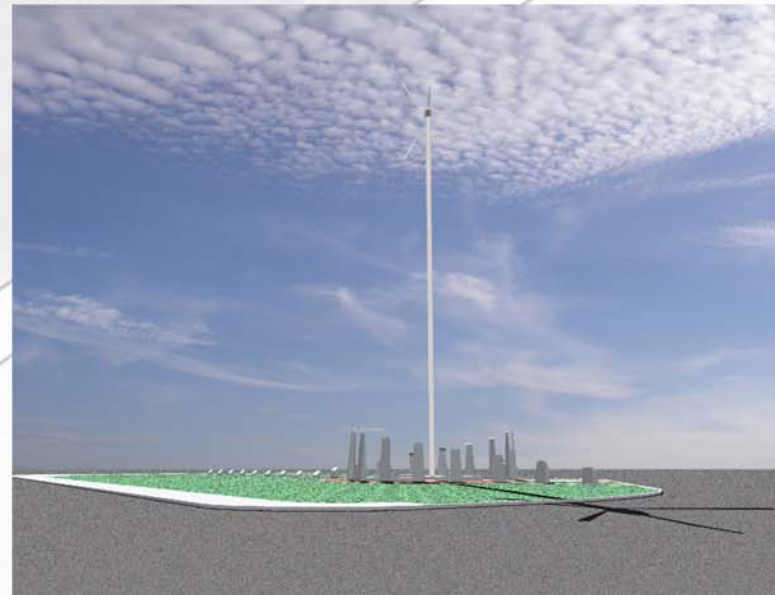

Rendering From Southeast Corner

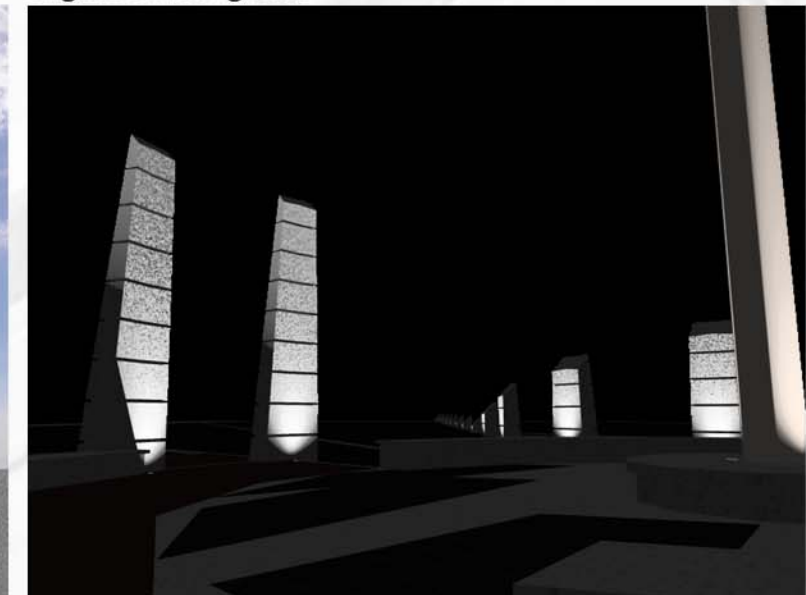

Night Rendering Looking West From Turbine Pole